

OPERATING INSTRUCTIONS

Hot Restart

If the engine is operated at higher ambient temperatures, then turned off and allowed to sit for a short time, it may not restart on the first pull. If necessary, use the following procedure: Failure to follow instructions can result in personal injury.



IMPORTANT SAFETY PRECAUTION

Turn the engine switch to the OFF position before performing the following procedure. This will prevent the engine for starting and running at maximum speed when the throttle is in the MAX. speed position. If the engine starts with the throttle in the MAX. speed position, the post driver will operate at maximum power. This may result in personal injury and damage to the post driver.

1. Turn the engine switch on the post driver to the OFF position.
2. Move the choke lever to the OPEN position.

3. Hold the throttle in the MAX speed position.

4. Pull the starter grip 3 to 5 times.

Follow the **STARTING THE ENGINE** procedure on the previous page and start the engine with the choke lever in the **OPEN** position.

Driving A Post:

Holding the post driver with your left hand on the foam grip and your right hand on the throttle will position the driver to direct the engine exhaust away from the operator (**Fig 6**) (See Exhaust Warning). Insert a post into the Fence Pro™ making sure the end of the post to be driven is in the correct location on the ground. (**Fig. 7**)



Fig. 6

Position the driver aligned and centered to the post. If not aligned properly, damage could be caused to the driver or the post.

Apply steady downward pressure to the handles and apply enough throttle to engage the clutch and hammer.

Once you are confident that the post is driving straight, apply full throttle to the driver until the post is driven to the desired depth.

Release the trigger dropping the engine RPM back to idle before removing from

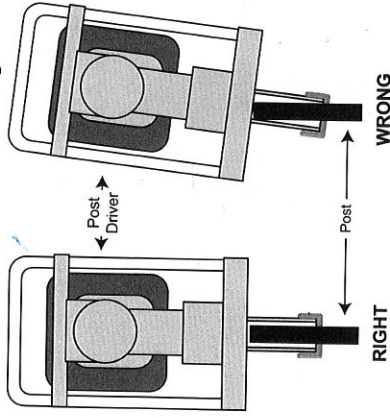

Fig. 7

OPERATING INSTRUCTIONS

the post. When the engine has returned to idle, proceed to the next post repeating the previous method of driving a post.

Installing a Chuck Adapter

Chuck Size: A chuck or chuck adapter that is too large for the post being driven may damage the driver and may batter the end of the post. Using the appropriate chuck adapter will align the post to optimum striking position. This prevents damage to the driver. See the chart below to specify the appropriate adapter for your application. Chucks and chuck adapters wear out and should be replaced as needed. Inspect your driver's chuck and chuck adapters frequently.

Type or Size of Post to be Driven	Chuck/Adapter Required
Fiberglass T-Post	1.75" (44.45mm) Adapter
T-Post	1.75" (44.45mm) Adapter
5/8" (15.87mm) to 3/4" (19 mm) Ground Rod	1" (25.4mm) Adapter
1" (25.4mm) to 1-5/8" (41.27) Post	1.75" (44.45mm) Adapter
1" (25.4mm) to 1-7/8" (47.62mm) Post	2" (50.8mm) Adapter
2" (50.8mm) to 2-3/8" (60.32 mm) Post	Master Chuck

The Rhino® Fence Pro™ equipped with the Rhino® Chuck-Lok™ Adapter System. It is comprised of a master chuck, the locking nut and two-piece adapters.

⚠ WARNING ALWAYS HAVE THE LOCKING NUT IN PLACE WHEN DRIVING POSTS:

The Chuck-Lok™ locking nut should always be tightened onto the master chuck to protect the chuck threads, even when not using an adapter. Failure to do so exposes the chuck to possible damage.

The two-piece adapter design is a solution for the occasional flared post. Should a post flare and lodge inside the chuck

when using the adapter, in most cases the operator can loosen the locking nut letting it slide down the post, then lift the driver off the post. The operator can quickly re-insert the adapter, secure them with the locking nut and resume driving posts. See Fig. 8 for steps for installing Chuck-Lok™ adapters.

Maintenance of the Fence Pro™

⚠ WARNING NEVER REFUEL WITH THE ENGINE HOT OR RUNNING

Never refuel your Fence Pro™ with the engine hot or running as there is a possibility the flammable fumes from the gasoline

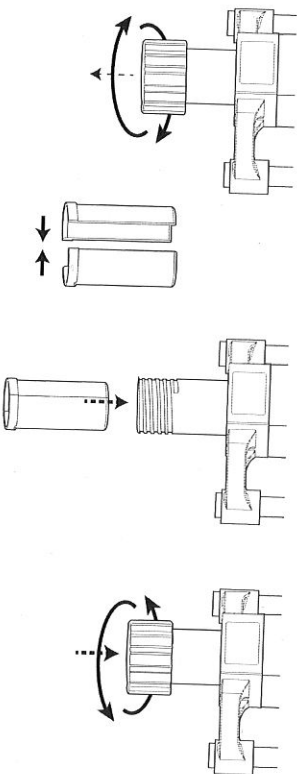

Fig. 8 - Hand tighten ONLY. No Tools.